

RoHS  
Compliant  
2002/95/EC

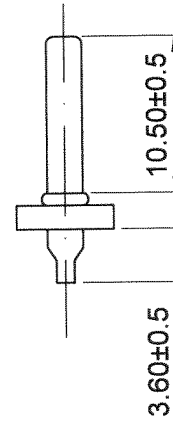
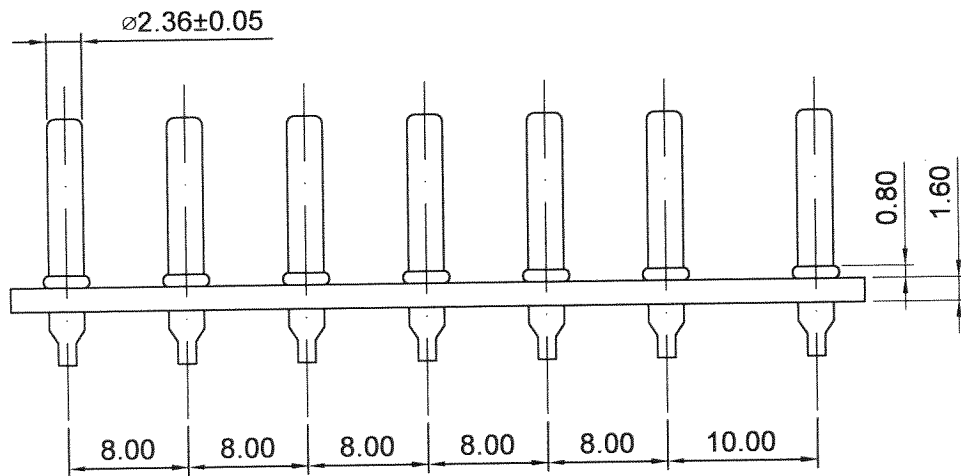
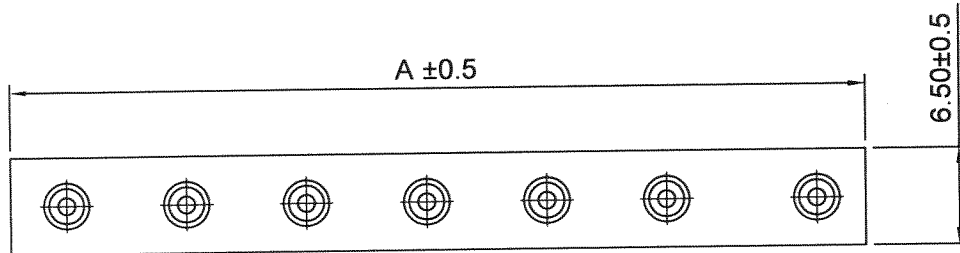

SPECIFICATION

POLES : 1-6

CURRENT RATING : 5A, AC, DC, 250V

WITHSTANDING VOLTAGE : 1500 VAC/min.

INSULATION RESISTANCE : 1000 MΩ min.

TEMPERATURE RANGE : -25°C ~ +85°C

CONTACT RESISTANCE : INITIAL VALUE / 10mΩ

MAX, AFTER ENVIRONMENTAL TESTING / 20mΩ MAX.

PIN : BRASS, TIN PLATED

INSULATOR MATERIAL : PHENOLIC BAKELITE(94V-0)

POLES	A DIM.
01	6.5
02	18
03	26
04	34
05	42
06	50

**JAWS** 兆旭股份有限公司  
JAWS CO., LTD.

7F-1, NO.31, Lane 169, Kang Ning Street,  
Hsichih, Taipei Hsien, Taiwan.  
TEL: 886-2-2692-2898  
FAX: 886-2-2692-2618  
Http://www.jaws.com.tw

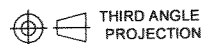

THIRD ANGLE  
PROJECTION

DESIGN UNITS  
■ mm □ INCH

SIZE:

A4

SCALE:

FREE

SHEET:

1/1

CPN NO.:

DAN NO.: S9607-076

TITLE:

φ2.36 WAFER

PARTS NO.:

4236A-WS-xxT-A

DWG NO.:

JAWS-SOP-4236A004

REV.

01

GENERAL TOLERANCES:

±0.30

DRAWN

游熾瑩

DATE 96/07/24

CHECK

郭坤峰

DATE 96/7/24

APPROVE

陳世官

DATE 96.7.25